

Timber Home Living

YOUR COZY

HOME GUIDE

big ideas for SMALL SPACES

20
efficient
**FLOOR
PLANS**
ALL SHAPES
& SIZES

- Cut costs by building small
- Downsize without sacrifice
- Discover hidden space

MAKE THE MOST OF EVERY ROOM!

- Guest Retreats
- Bathrooms
- Outdoor Areas

MAY/JUNE 2018
\$5.99US \$6.99CAN



8 88526 39198 3 06>
Display Until June 5, 2018

Living the Dream

This Colorado beauty was three decades in the making —
and well worth the wait.

BY SUZANNA LOGAN | PHOTOS BY JAMES RAY SPAHN

Sitting at the edge of a national forest, the home offers forever-protected million dollar views and plenty to do, with trails for hiking, horseback riding and biking nearby.

Pris Hodges is one of those people who, when she puts her mind to something, she does it. So, when she sat down with her mother in the mid-1980s and sketched out her dream home, she knew she would build it ... someday.

Only someday didn't come the next year, the next decade, or even the decade after that. Still, her dream lived on in those pictures, tucked away out of sight, but never out of mind.

Finally, Pris felt a nudge that it was time. She purchased a 55-acre piece of land in Crested Butte, Colorado, where she used to go skiing as a child. Next, she pulled the sketches out — their preciousness amplified by the passing of her mother since their creation — and began making plans to make Hodges Hideaway a reality. “What my mom always said was, ‘Get a vision — draw it out in your mind exactly how you want it — keep it, then

make it come to life,’” she says.

And, that's exactly what Pris did. She then joined forces with Sunlit Architecture and Steve and Paul Pike from Pike Builders, Inc. in Gunnison, Colorado, and detailed everything she and her mom had planned. The vision? “A little cabin in the woods,” Pris says. They executed that vision so well that if you blink you could miss the home, tucked into a hillside so that the three-story structure appears to be a single







level that blends organically into its surroundings.

“So often everything is designed with big rooflines and big gabled ends and lots of glass. This was designed to be like something you would see in the middle of the woods,” explains Steve Pike. “This isn’t your prototypical mountain home,” he continues. “It truly has this feel of being an old trapper’s cabin.”

Furthering the historic sense of the home, it’s made of hand-hewn timbers (from an old mill in California built at the turn of the century) combined with chinking. “We developed a process

where we can add sand, sawdust and even straw to synthetic chinking so it has an older look,” Pike says. Inside, a system of heavy timber trusses and hand-forged wrought-iron tie beams add authenticity to the structure, along with reclaimed boards on the ceilings and three cobblestone fireplaces.

In addition to being the muse for the simple cabin vision, Pris’ mom was the guiding force behind the specifics, too. For starters, the kitchen needed to be laid out in a triangle “for good workflow,” says Pris. The bedrooms had to be roomy — “there has to be enough space

FAR LEFT: The open living area is filled with striking details, from the timber trusses with steel tie rods to the rustic glass chandelier and cowhide rug. The life-size Lone Ranger art posters stand sentinel over the entire space. An open loft above is a favorite spot for watching movies and playing games.

ABOVE: The kitchen was designed for cooking and conversation. Guests can pull up a seat at the island — created by placing a 3-inch-thick slab of maple atop a base made of alder and local cobblestone — to take in all the action. Mercury glass pendants and stainless-steel appliances add polish to the otherwise rustic space.



CLOCKWISE FROM ABOVE: A greenhouse, just steps from the kitchen, is filled with herbs, sugar snaps, tomatoes and strawberries. “I don’t ever buy vegetables,” says Pris. “I go out and pick my salad.” ■ An exposed wall, with varied sizes of timbers and chinking, gives one of the three guest bedrooms an authentic cabin feel. ■ Located just off the living room behind the double-sided fireplace, the sunroom with overstuffed arm chairs and wall-to-wall windows is the perfect place to take in the valley views. ■ A painted vanity in the junior suite adds a pop of color to the neutral space. ■ A landscape architect surrounded the home with native plantings and rocks from the ranch to give the property a natural, low-maintenance feel.



to walk around the bed so it's easier to make." And because you should "always have somewhere you can sit outside," there needed to be an outdoor area dedicated to blissed-out lounging. Lastly, there had to be a barn and stables that would allow the property to serve as an animal sanctuary in honor of her twin sister, Pam's, passion for animals.

To her original list, Pris added a few more requirements: three ensuite bedrooms to ensure comfort and privacy for weekend guests, an easy-flowing open floor plan to encourage conversation, a loft for movie-watching, a separate basement apartment and, above all, perfectly framed views of the jaw-dropping landscape that extends for miles from the edge of the property.

With such striking views outside, the look inside the home had big boots to fill. The finishes include century-old hardwood floors (with their original patina, of course), log-topped vanities, hand-made cabinetry and barn doors galore. When it was time to add the final touches to the western-themed space, Pris was the girl for the job. She had once owned an antique store and used many of those treasures to give the home a collected-over-time vibe. "A lot of those things sat in a warehouse for ten years because I knew I wanted to use them someday," she says.

Now that she has settled into her long-awaited dream home, what's it really like living in a place where your nearest neighbors are deer, elk and a mama bear and her cubs? "It's quiet and peaceful," says Pris. "You don't hear anything but the swish of the leaves, except maybe the rain on the tin roof sometimes. When I'm there, I have this feeling of, 'Here you go, mom.'"

With such striking views outside, the look inside the home had big boots to fill. The finishes include century-old hardwood floors, hand-made cabinetry and barn doors galore.



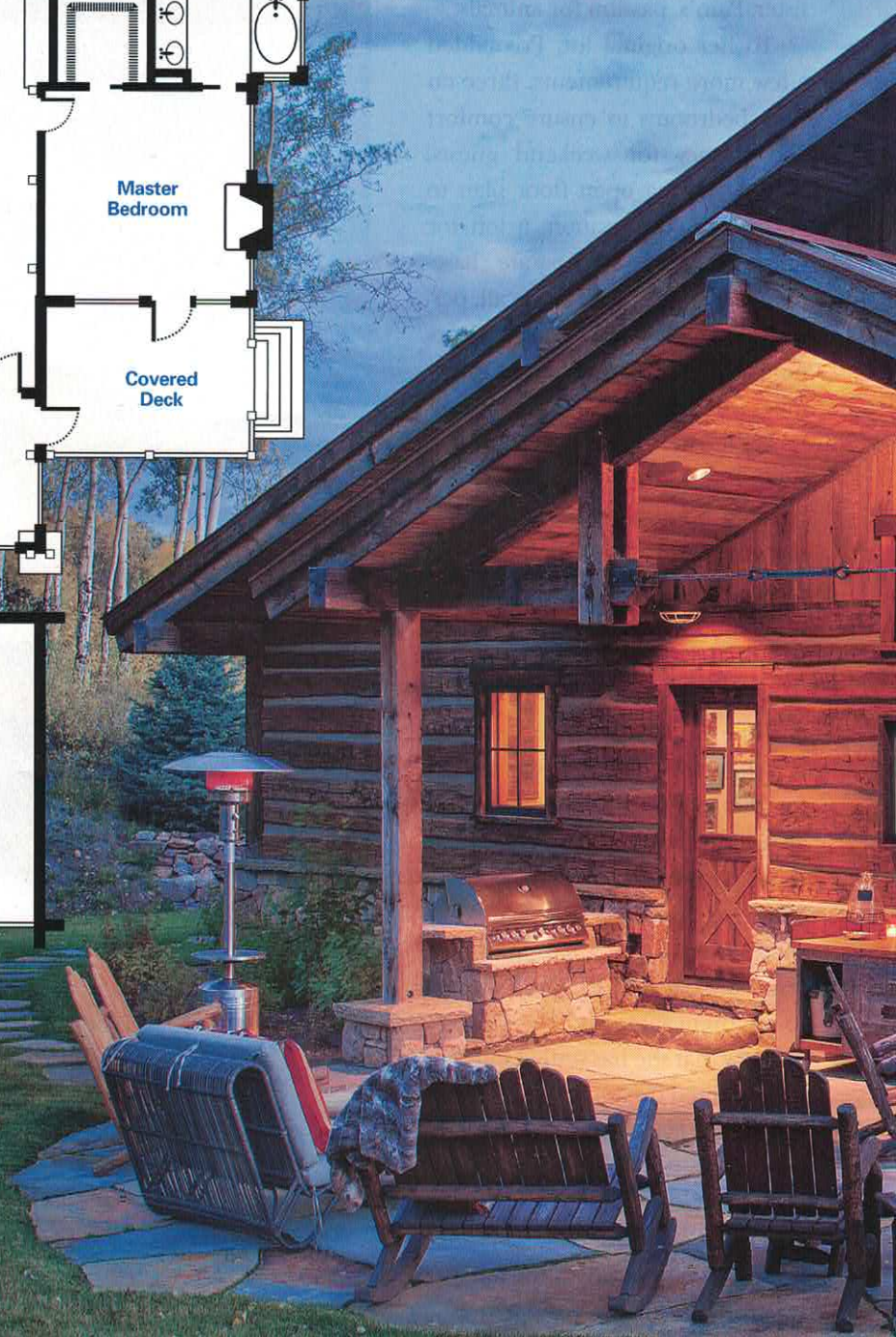
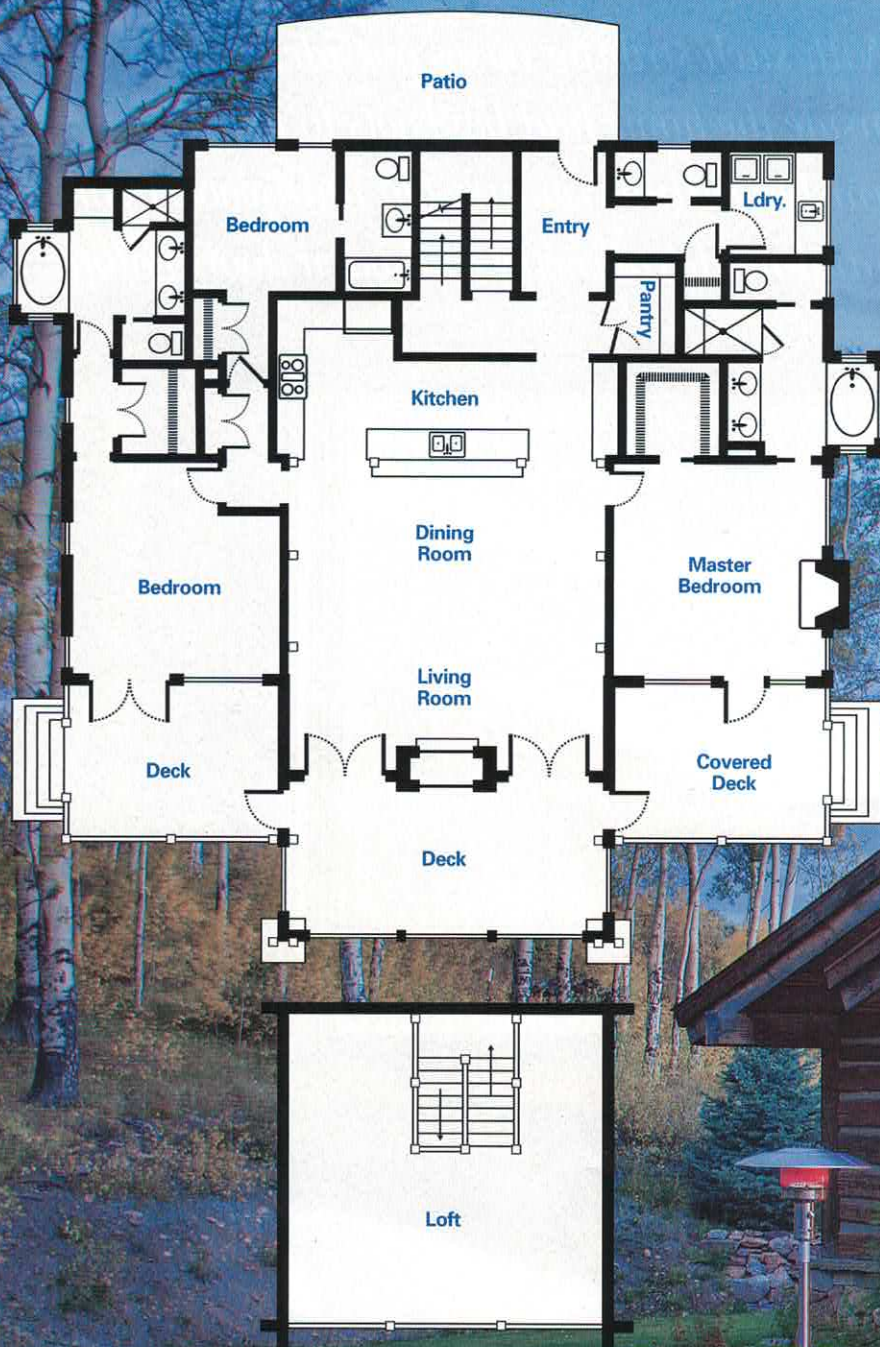

A simple roof line with low pitches sets the tone for the home. Tucked into a hillside and nestled into a grove of aspen and fir, the understated structure all but disappears into its natural surroundings. A stone patio with fire pit overlooks the landscape and provides plenty of room for outdoor entertaining.

home details

SQUARE FOOTAGE: 5,805 (including separate apartment and garage)

ARCHITECT: Sunlit Architecture,
970-349-5311; sunlitarchitecture.com

BUILDER: Pike Builders,
970-641-6600; pikebuilders.com



To see more photos of this home,
log on to timberhomeliving.com.